



**Rebates HELP!**  
Healthy & Efficient Landscape Programs



# 75¢/sqft DRIP Conversion

**Rebate Program**

## 5 Easy Steps

### Step 1 – Get informed

- Santa Clarita Valley Water Agency (SCV Water) now offers a **75¢/sqft** rebate when you replace your old spray sprinklers with high-efficiency **DRIP Irrigation** equipment to make your irrigation system lean, mean and green! Official program rules and requirements are listed on the Help Rebate voucher or in the Lawn Replacement Incentive Program's Terms and Conditions; both can be downloaded online at [conserve.yourscvwater.com](https://conserve.yourscvwater.com).

### Step 2 – Make a plan and materials list

- Identify any non-turf (shrubs, trees, flower, food crops) irrigation zones that use spray irrigation.
- Count the number of unique zones (areas) that you plan to convert from spray to Drip.
- Measure the area(s) for each zone that you going to convert (both in square feet and in linear feet).
- Count the number of spray heads in the zone that you are going to convert to DRIP or cap.

### Step 3 – Buy what you need

- Use provided worksheet to record the number of Conversion or Control Zone Kits, Drip Lines, Drip Tubing, Drip Emitters, Caps, Stakes, Pipe Nipples, and other materials needed for each zone, and take it to a local irrigation supply store where you will receive assistance in selecting the qualified DRIP products/equipment that will work best for your application.

### Step 4 – Convert

- Convert the spray areas to DRIP and make any necessary adjustments to your irrigation controller. Drip Irrigation Systems put out fewer gallons per hour and irrigation runtimes may need to be adjusted accordingly.

### Step 5 – Create an Account, Submit Your Rebate Request, and Soak in the savings!!!

- Using the Droplet Portal ([yourscvwater.dropletprograms.com](https://yourscvwater.dropletprograms.com)) create an account or access existing account to upload your original receipt(s) along with pictures showing your installed drip irrigation equipment. Rebates will be issued as a credit to your water bill or a check per discretion of SCV Water.

1.

**Get Informed –**

SCV Water now offers a **75¢/sqft** rebate when you replace your old non-turf (shrubs, trees, flower, food crops) spray sprinklers with high-efficiency **DRIP Irrigation** equipment to make your irrigation system lean, mean and green!



**Before** – Inefficient Spray for Flower Beds



**After** - Efficient Drip for Flower Zones

Low Water Use Ground Cover Plants including Flower and Shrub Zones are an ideal candidate for Drip Irrigation.

## 2. Make a Plan –

- A. Start by inspecting your irrigation system to better understand what types of Drip Irrigation you might need.
  - 1. Making a general drawing that identifies:
    - 1. The total area of the conversion zone (square feet),
    - 2. The location and number of the current spray bodies,
    - 3. The location of plants, including plant type(s) and/or density.

(A sample drawing is located at the back of this packet).

Insert drawing here

3.

**Buy What You Need –**

- Use provided worksheet to record the number of Conversion or Control Zone Kits, Drip Lines, Drip Tubing, Drip Emitters, Caps, Stakes, Pipe Nipples, and other materials needed for each zone, and take it to a local irrigation supply store where you will receive assistance in selecting the qualified DRIP products/equipment that will work best for your application.

**Measure the area in square feet –** *Area of the converted zone (Width X Length) = \_\_\_\_\_ sqft*

•Enter the parts and pieces you need to convert to your DRIP Irrigation System.

Number DRIP Conversion Kits/Manifolds = \_\_\_\_\_

Length of DRIP Tubing and DRIP Line = \_\_\_\_\_ or Number Drip Tube Rolls = \_\_\_\_\_

Number of DRIP Emitters (or Plants) = \_\_\_\_\_ Small, \_\_\_\_\_ Medium, \_\_\_\_\_ Large

Number of Micro-Sprinklers = \_\_\_\_\_ Number of Rise Assemblies = \_\_\_\_\_

Number of Cap Offs = \_\_\_\_\_

Number of Stakes (Total Length of Drip Tubing / 3ft) = \_\_\_\_\_

Number of Pipe Nipples = \_\_\_\_\_

### 3.

### Buy What You Need (Remember to Keep Your Receipts) –

- Products are available at the following irrigation/home supply stores.
- Select the Drip Conversion Product Types that best match your needs from the Eligible Products List.

#### Aquaflor

28317 Kelly Johnson  
Santa Clarita, CA 91355  
(661) 257-0909

#### Ewing

27726 Avenue Hopkins  
Santa Clarita, CA 91355  
(661) 257-3600

#### Hydroscape

28145 Ave Crocker  
Valencia, CA 91355  
(661) 775-0930

#### Home Depot

28033 Newhall Ranch Rd. #1055  
Valencia, CA 91355  
(661) 702-9925

#### Lowes

26415 Bouquet Canyon Rd  
Valencia, CA 91355  
(661) 297-1400



### Eligible Drip Product Types:

- Drip Conversion Kits (Spray to Drip)
- Pre-Installed Emitter Tubing
- Punch-in Emitters
  - Not to exceed 4 gallons per hour
- Drip Bubblers
  - Not to exceed 4 gallons per hour
- Micro-Sprinkler Heads

### Products that DO NOT Qualify:

- Patio Kits
- Hose Connection Drip Kits
- Soaker Hose

Note: Eligible product types are subject to change and are updated on SCV Water's website at [conserve.yourscvwater.com](http://conserve.yourscvwater.com).



## 4. Make the Changes –

- Install Drip Systems and Drip Conversion Kit and make any necessary adjustments to your irrigation controller.
- Drip Systems put out fewer gallons per hour so times may need to be adjusted accordingly.

### - Installing Inline Drip Conversion Kits Only -

**Tools Needed:** shovel, hammer, scissors

**Time Per Zone:** Approx. 1-2 Hours

**Step 1** – Dig around the existing spray body that is to be converted

**Step 2** – Unscrew the old body

**Step 3** – Screw in the Drip Conversion Kit

**Step 4** – Connect the Inline Drip Tubing to the Drip Conversion Kit

**Step 5** – Run the Drip Tubing throughout the converted irrigation zone

**Step 6** – Stake the tubing to the ground every 3-4 feet

**Step 7** – Tie/Seal the end of the Drip Tubing Line

**Step 8** – Cap off remaining Spray Heads and check for leaks

**Step 9** – Cover area with mulch and proceed to recommendations on **Time Management and Scheduling**

***Note:** Drip System manufacturers suggest an operational pressure of 30 or 40 Psi. Most Drip Conversion Kits come equipped with a pressure regulator. We do not recommend that you operate a Drip system without proper pressure regulation.*

### - Installing Inline Drip Conversion Kits with Additional Drip Emitters

**Tools Needed:** shovel, hammer, scissors, Drip Irrigation hole punch tool screwdriver,

**Time Per Zone:** Approx. 1-2.5 Hours.

**Step 1** – Dig around the existing spray body that is to be converted

**Step 2** – Unscrew the old body

**Step 3** – Screw in the Drip Conversion Kit

**Step 4** – Connect the Inline Drip Tubing to the Drip Conversion Kit

**Step 5** – Run the Drip Tubing throughout the converted irrigation zone

**Step 6** – Punch a hole in the Drip Tubing where you plan to run an extension to a tree, or other isolated plant

**Step 7** – Connect the Drip Tubing to the supply line (Inline Drip Tubing) and run to the tree or other isolated plant

**Step 8** – Connect the right sized emitter to the Drip Tubing and stake to the ground (multiple emitters may be needed for large plants including trees, consider using a tree ring)

**Step 9** – Stake the tubing to the ground

**Step 10** – Tie/Seal the end of the Drip Tubing Line

**Step 11** – Cap off remaining Spray Heads and check for leaks

**Step 12** – Cover area with mulch and proceed to recommendations on **Time Management and Scheduling**



***Note:** Drip System manufacturers suggest an operational pressure of 30 or 40 Psi. Most Drip Conversion Kits come equipped with a pressure regulator. We recommend that you do not operate a Drip system without proper pressure regulation.*

### - Time Management and Scheduling-

**Step 1** – Drip Systems have a lower precipitation rate (the amount of water delivered per hour in inches) than conventional spray heads. Times may need to be adjusted to adjust for the lower water output. Conventional spray heads deliver on average 1.5"/hr where Drip Systems run from .3"/hr to 1.1"/hr .

**Step 2** – When using with an advanced Weather Based Irrigation Controller (WBIC) set output rate to DRIP.

## 5. Soak in the Savings–

- Using the Droplet Portal ([yourscvwater.dropletprograms.com](http://yourscvwater.dropletprograms.com)) create an account or access existing account to upload your original receipt(s) along with pictures showing your installed drip irrigation equipment. Rebates will be issued as a credit to your water bill or a check per discretion of SCV Water.
- Rebates will be issued by SCV Water in accordance with the Official Rules and Regulations identified on the HELP Rebate Voucher and/or as stipulated in the Lawn Replacement Incentive Program Terms and Conditions.
- Enjoy your landscape with decreased water use and lower water costs.

### - Create an Account or Use Existing Account -

Online: [yourscvwater.dropletprograms.com](http://yourscvwater.dropletprograms.com)

Questions – Please Contact us @:

Phone Number: 661-513-1244

Email: [Conservation@scvwa.org](mailto:Conservation@scvwa.org)

### - Submitting Your Documentation -

Customers are required upload original receipts and provide completed W-9 to SCV Water.



Please provide original receipt and pictures of your new nozzles in action.



### - Receiving Your Rebate -

- Rebates are for 75¢/sqft for Spray Irrigation areas that are converted to Drip Irrigation (not to exceed the cost of actual conversion project, including parts, pieces and labor)
- DRIP Conversion Rebates may not exceed an annual amount of \$1,875 per residential customer and \$10,000 per non-residential customer, unless otherwise authorized has been obtained by the Agency (rebate eligibility depends on total landscaped area)
- Official HELP DRIP Conversion rebate program rules are listed on the rebate voucher
- Rebates will be issued by SCV Water in accordance with the Official Rules and Regulations identified on the HELP Rebate Voucher and/or as stipulated in the Lawn Replacement Incentive Program Terms and Conditions.
- Water savings results will vary.

For further assistance, email us at:  
[Conservation@scvwa.org](mailto:Conservation@scvwa.org)

## 6.

**Educational Materials –**

- This page includes references to educational materials that may assist you with your DRIP Conversion Project.

*SCV Water shall not be liable for any damages or injury due to defects in material or workmanship affecting the HE device(s), nor due to negligent or improper installation of the HE device(s). The manufacturer of the HE device(s) is solely responsible for any and all defects in materials and workmanship affecting the product(s).*

**Online Video Resources\*****Drip Conversion Kit Installation Videos**

**AGRIFIM** DRIP Conversion Kit Installation - <http://www.wyattsupply.com/how-to/nds-agrifim-drip-conversion-kit>

**California Gardening** The Manifold Technique - <http://www.youtube.com/watch?v=LezqEEb5QSk>

**Orbit** Drip Made Easy - [http://www.youtube.com/watch?v=qa3\\_vgHmCAQ](http://www.youtube.com/watch?v=qa3_vgHmCAQ)

**Rain Bird** DRIP Retrofit Video - <http://www.youtube.com/watch?v=lk-bQxQnkVY>

**Spray Zone to Drip Retrofit Videos**

**Bay Friendly** Spray Zone to Drip Retrofit - <http://www.youtube.com/watch?v=LeLLIhcv8Cc>

*\* DRIP Conversion and/or Retrofit Videos are informational only and SCV Water does not support, verify, or otherwise guarantee the workmanship affecting the HE device(s).*

**DRIP Manufacturers\***

**Agrifim** – [www.ndspro.com](http://www.ndspro.com)

**DIG Corp** - [www.digcorp.com](http://www.digcorp.com)

**DripWorks** - [www.dripworks.com](http://www.dripworks.com)

**Hunter** - [www.hunterindustries.com](http://www.hunterindustries.com)

**Mister Landscaper** – [www.misterlandscaper.com](http://www.misterlandscaper.com)

**Netafim** - [www.netafimusa.com](http://www.netafimusa.com)

**Rain Bird** - [www.rainbird.com](http://www.rainbird.com)

**Raindrip** - [www.raindrip.com](http://www.raindrip.com)

**Salco** - <http://salcodrip.com/>

**Toro** - [www.toro.com](http://www.toro.com)

**Orbit** - [www.orbitonline.com](http://www.orbitonline.com)

*\* DRIP Manufacturer list is informational only and SCV Water does not support, verify, or otherwise guarantee the workmanship affecting the HE device(s).*

*Thank you for your commitment to water conservation and water use efficiency!!!*



## 2. Make a Plan – **SAMPLE**

A. Start by inspecting your irrigation system to better understand what types of Drip Irrigation you might need.

1. Making a general drawing that identifies:
  1. The total area of each conversion zone (square feet),
  2. The location and number of the current spray bodies,
  3. The location of plants, including plant type(s) and/or density.

(A sample drawing is located below).

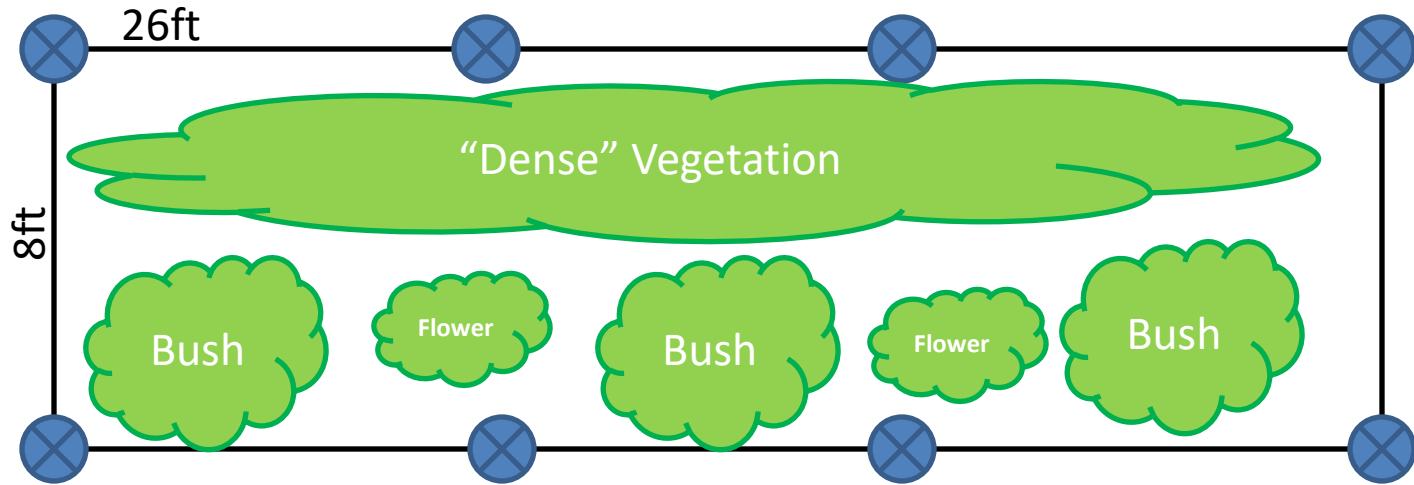

**8ft X 26ft = 208sqft**

 = Current Spray Head Location(s) and Count (8)

 = Make note of the Location of the Plants, Plant Type(s) and/or Density (Sparse, Dense)